

INDEX OF PROJECT SHEETS

- 01 COVER SHEET
- 02 SIGNATURE SHEET
- 03 GENERAL NOTES AND TABULATION OF QUANTITIES
- 04 TYPICAL SECTIONS
- 05 DEMOLITION AND CURB MODIFICATION DETAILS
- 06 SIGNING AND MARKING PLAN
- 07 SIGNING AND MARKING PLAN

CITY OF GAINESVILLE PRELIMINARY PLANS

FOR NW 8TH AVENUE LANE REPURPOSING

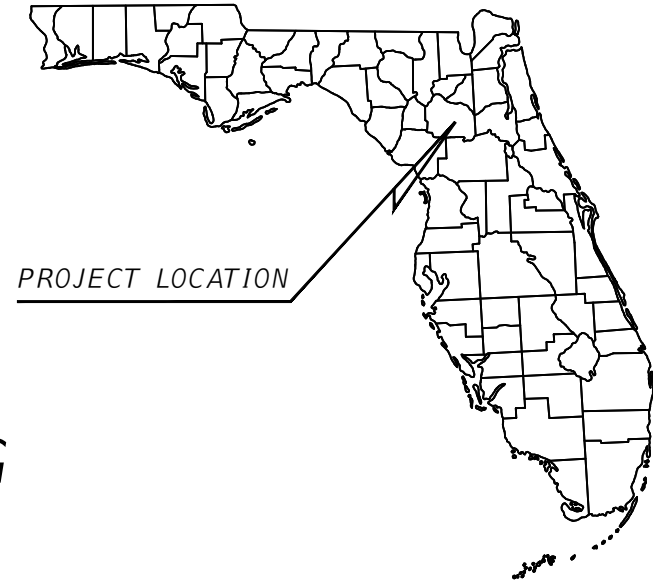

UTILITY AGENCY OWNERS

- | | |
|---|---|
| <p>AT&T DISTRIBUTION
DINO FARRUGGIO
6628 LAKESIDE ROAD
WEST PALM BEACH, FL 33411
(561) 683-2729</p> <p>COX CABLE - ALACHUA
RANDY EHLERS
6020 NW 43RD ST
GAINESVILLE, FL 32653
(352) 337-2009</p> <p>UNITI FIBER
BOB MENSCHING
107 ST FRANCIS ST, SUITE 1800
MOBILE, AL 36602
(904) 718-8152</p> <p>MCI INVESTIGATIONS TEAM
3301 MATRIX DR
RICHARDSON, TX 75082
(800) 624-9675 EXT 2</p> <p>CITY OF GAINESVILLE TRAFFIC MANAGEMENT
CHRIS DOLAN
405 NW 39TH AVE, BLDG E
GAINESVILLE, FL 32609
(352) 393-8180</p> | <p>GAINESVILLE REGIONAL UTILITIES WATER/WASTEWATER
ANDREW ROBERTS
P.O. BOX #147117 STATION E3F
GAINESVILLE, FL 32614-7117
(352) 393-1639</p> <p>GAINESVILLE REGIONAL UTILITIES FIBER
MICHAEL CHAPPELL
4747 N MAIN ST
GAINESVILLE, FL 32609
(352) 393-6923</p> <p>GAINESVILLE REGIONAL UTILITIES GAS
PHILLIP LANCASTER
P.O. BOX 147117, STATION SG-45
3805 NW 97TH BLVD
GAINESVILLE, FL 32614-7117
(352) 334-6078</p> <p>GAINESVILLE REGIONAL UTILITIES ELECTRIC
RENEE ZAMOT-AYALA
3805 NW 97TH BLVD
GAINESVILLE, FL 32614-7118
(352) 393-6039</p> |
|---|---|

GOVERNING STANDARDS AND SPECIFICATIONS:
FLORIDA DEPARTMENT OF TRANSPORTATION STANDARD PLANS FOR ROADWAY AND BRIDGE CONSTRUCTION DATED FY 2022-2023, AND FLORIDA DEPARTMENT OF TRANSPORTATION STANDARD SPECIFICATIONS FOR ROAD AND BRIDGE CONSTRUCTION DATED JULY 2022, AS AMENDED BY CONTRACT DOCUMENTS.

PROJECT OWNER AND CONSULTANTS

- | | |
|--|---|
| <p>OWNER/DEVELOPER/APPLICANT:
CITY OF GAINESVILLE
200 EAST UNIVERSITY AVE
GAINESVILLE FL 32601
(352) 334-5000</p> <p>CIVIL ENGINEERING CONSULTANT:
KIMLEY-HORN AND ASSOCIATES, INC.
800 SW 2ND AVENUE,
SUITE 100,
GAINESVILLE, FL 32601
(352) 374-3274</p> | <p>SURVEYOR:
DEREN LAND SURVEYING
4605 NW 6TH STREET, SUITE H
GAINESVILLE, FL 32609
(352) 331-0010</p> |
|--|---|

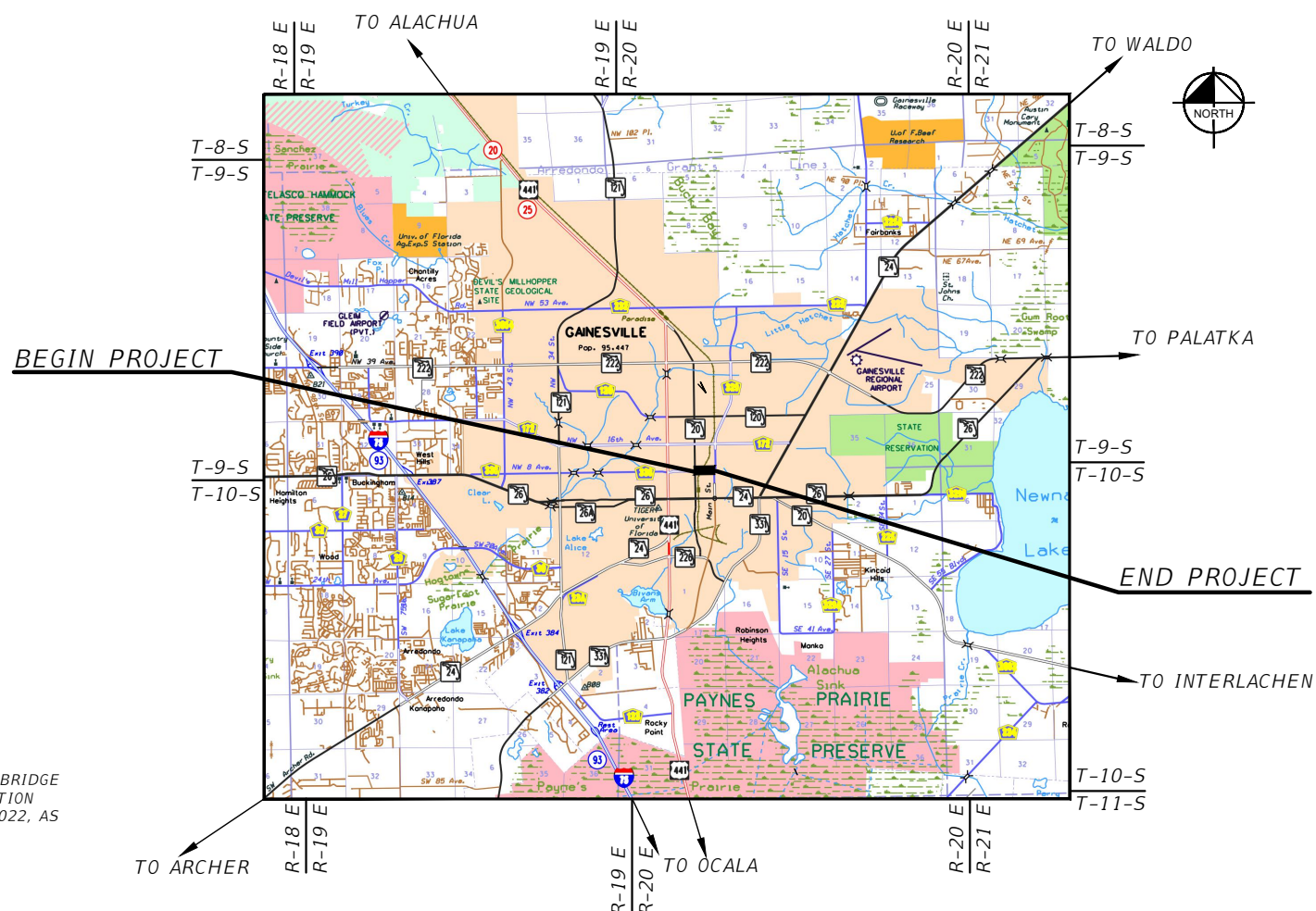

ROADWAY SHOP DRAWINGS TO BE SUBMITTED TO:

KIMLEY-HORN AND ASSOCIATES, INC.
ALI H. BRIGHTON, P.E.
800 SW 2ND AVENUE,
SUITE 100,
GAINESVILLE, FL 32601

PLANS PREPARED BY:

Kimley»Horn

© 2023 KIMLEY-HORN AND ASSOCIATES, INC.
800 SW 2ND AVENUE,
SUITE 100,
GAINESVILLE, FL 32601
(352) 374-3274
REGISTRY 35106

NOTE: THE SCALE OF THESE PLANS MAY HAVE CHANGED DUE TO REPRODUCTION.

MARCH 22, 2023
90% SUBMITTAL
NOT FOR CONSTRUCTION

CITY OF GAINESVILLE
PROJECT MANAGER:
DEBBIE LEISTNER, PTP

CONSTRUCTION PLANS
ENGINEER OF RECORD: ALI H. BRIGHTON, P.E.
P.E. NO.: 77731

SHEET NO.
01

This document, together with the concepts and designs presented herein, is intended only for the specific purpose and client for which it was prepared. Reuse of and improper reliance on this document without written authorization and adaptation by Kimley-Horn and Associates, Inc. shall be without liability to Kimley-Horn and Associates, Inc.

This document, together with the concepts and designs presented herein, is intended only for the specific purpose and client for which it was prepared. Review of and improper reliance on this document without written authorization and adaptation by Kimley-Horn and Associates, Inc. shall be without liability to Kimley-Horn and Associates, Inc.

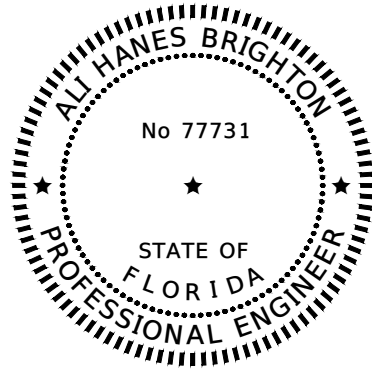

THIS ITEMS HAS BEEN DIGITALLY SIGNED AND SEALED BY

ON THE DATE ADJACENT TO THE SEAL

PRINTED COPIES OF THIS DOCUMENT ARE NOT CONSIDERED SIGNED AND SEALED AND THE SIGNATURE MUST BE VERIFIED ON ANY ELECTRONIC COPIES.

KIMLEY-HORN AND ASSOCIATES, INC.
800 SW 2ND AVENUE, SUITE 100
GAINESVILLE, FLORIDA 32601
REGISTRY 35106
ALI H. BRIGHTON, P.E. 77731

THE ABOVE NAMED PROFESSIONAL ENGINEER SHALL BE RESPONSIBLE FOR THE FOLLOWING SHEETS IN ACCORDANCE WITH RULE 61G15-23.004, F.A.C.

SHEET NO.	SHEET TITLE
01	COVER SHEET
02	SIGNATURE SHEET
03	GENERAL NOTES AND TABULATION OF QUANTITIES
04	TYPICAL SECTIONS
06	SIGNING AND MARKING PLAN
07	SIGNING AND MARKING PLAN

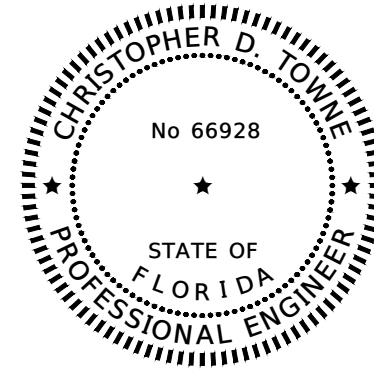

THIS ITEMS HAS BEEN DIGITALLY SIGNED AND SEALED BY

ON THE DATE ADJACENT TO THE SEAL

PRINTED COPIES OF THIS DOCUMENT ARE NOT CONSIDERED SIGNED AND SEALED AND THE SIGNATURE MUST BE VERIFIED ON ANY ELECTRONIC COPIES.

KIMLEY-HORN AND ASSOCIATES, INC.
800 SW 2ND AVENUE, SUITE 100
GAINESVILLE, FLORIDA 32601
REGISTRY 35106
CHRISTOPHER D. TOWNE, P.E. 66928

THE ABOVE NAMED PROFESSIONAL ENGINEER SHALL BE RESPONSIBLE FOR THE FOLLOWING SHEETS IN ACCORDANCE WITH RULE 61G15-23.004, F.A.C.

SHEET NO.	SHEET TITLE
02	SIGNATURE SHEET
05	DEMOLITION AND CURB MODIFICATION DETAILS

REVISIONS		DATE	<p>© 2023 KIMLEY-HORN AND ASSOCIATES, INC. 800 SW 2ND AVENUE, SUITE 100, GAINESVILLE, FL 32601 PHONE: 352-374-3274 WWW.KIMLEY-HORN.COM REGISTRY 35106</p>	LICENSED PROFESSIONAL	CITY OF GAINESVILLE NW 8TH AVE MODIFICATIONS			SIGNATURE SHEET	SHEET NO.
DATE	DESCRIPTION	MARCH 2023		ALI H. BRIGHTON P.E.	ROAD NO.	COUNTY	PROJECT NO.		02
- -	NOT FOR CONSTRUCTION			77731	NW 8TH AVE	ALACHUA	142107008		

GENERAL CONSTRUCTION NOTES:

- SEE TOPOGRAPHIC SURVEY DATED 10/21/2022 BY DEREN LAND SURVEYING FOR SURVEY INFORMATION AND NOTES.
- STAGING AND MATERIAL STORAGE SHALL NOT BE CONDUCTED ON ABUTTING PRIVATE PROPERTY WITHOUT WRITTEN APPROVAL FROM THE OWNER.
- THE CONTRACTOR IS TO MAINTAIN AND KEEP STREET NAME IDENTIFICATION SIGNS VISIBLE DURING CONSTRUCTION OPERATIONS, IN ORDER TO FACILITATE EMERGENCY VEHICLE TRAFFIC. PLACEMENT OF BUSINESS ENTRANCE SIGNS AND CHANNELIZING DEVICES ARE TO BE IN ACCORDANCE WITH THE FLORIDA DEPARTMENT OF TRANSPORTATION STANDARD PLANS FOR ROADWAY AND BRIDGE CONSTRUCTION (INDEX 102 SERIES AS APPLICABLE).
- THE CONTRACTOR SHALL PROVIDE ACCESS TO ALL RESIDENCES AND BUSINESSES DURING THE ENTIRE CONSTRUCTION PERIOD.
- ALL CONSTRUCTION SHALL BE COMPLETED IN ACCORDANCE WITH THE FDOT STANDARD SPECIFICATIONS FOR ROAD AND BRIDGE CONSTRUCTION AND CONTRACT DOCUMENTS.
- CONTRACTOR IS RESPONSIBLE TO VERIFY EXISTING SITE CONDITIONS PRIOR TO CONSTRUCTION. IF A DISCREPANCY SHOULD ARISE, THE CONTRACTOR SHALL IMMEDIATELY NOTIFY THE PROJECT ENGINEER IN WRITING FOR PROPOSED RESOLUTION OR CLARIFICATION.
- JOB SAFETY SHALL BE IMPLEMENTED AT ALL TIMES. IT IS THE CONTRACTOR'S RESPONSIBILITY TO BE FAMILIAR WITH OSHA STANDARDS AND TO ABIDE BY THEM AS WELL AS ANY OTHER LOCAL, STATE, AND FEDERAL REGULATIONS.
- DAMAGE TO UTILITIES, STRUCTURES OR PROPERTY ON OR ADJACENT TO THE PROJECT SITE CAUSED BY CONSTRUCTION ACTIVITIES SHALL BE THE RESPONSIBILITY OF THE CONTRACTOR.
- THE CONTRACTOR SHALL NOTIFY THE CITY OF GAINESVILLE PUBLIC WORKS DEPARTMENT AND THE FLORIDA DEPARTMENT OF TRANSPORTATION A MINIMUM OF 48 HOURS PRIOR TO THE COMMENCEMENT OF ANY CONSTRUCTION.
- THESE PLANS REFLECT CONDITIONS KNOWN DURING PLAN DEVELOPMENT. IN THE EVENT THAT ACTUAL CONDITIONS PREVENT THE APPLICATION OF THESE PLANS AND SPECIFICATIONS IN THE CONSTRUCTION OF THE WORK, THE CONTRACTOR SHALL PROMPTLY NOTIFY THE ENGINEER IN CHARGE PRIOR TO FURTHER CONSTRUCTION ACTIVITY.
- THE CONTRACTOR AND SUBCONTRACTORS ARE HEREBY REQUIRED TO PROMPTLY NOTIFY THE PROJECT ENGINEER OF ANY DISCREPANCIES OR CONFLICTS FOUND IN THE PLANS OR SPECIFICATIONS, SO THEY ARE CLARIFIED BY THE ENGINEER.
- NO CHANGES TO THE WORK AS SHOWN ON THESE PLANS SHALL BE MADE WITHOUT PRIOR WRITTEN APPROVAL OF THE PROJECT ENGINEER. CONTRACTOR SHALL CHECK ACTUAL SITE CONDITIONS PRIOR TO CONSTRUCTION. ANY NEED FOR CLARIFICATION OF PROPOSED IMPROVEMENTS OR FOR RESOLUTION OF DISCREPANCIES SHALL BE IMMEDIATELY BROUGHT TO THE ATTENTION OF THE PROJECT ENGINEER.
- THE PROJECT ENGINEER OR REPRESENTATIVE SHALL HAVE ACCESS TO THE WORK SITE AT ALL TIMES.
- ALL EXISTING STORMWATER DRAINAGE PATTERNS AND CHANNELS OUTSIDE THE CONSTRUCTION AREAS SHOWN ON THESE PLANS ARE TO BE MAINTAINED. THE CONTRACTOR SHALL NOTIFY THE ENGINEER IF THE WORK APPEARS TO INTERRUPT AN EXISTING STORMWATER DRAINAGE PATTERN. THE CONTRACTOR SHALL MAINTAIN A CLEAR PATH FOR ALL SURFACE WATER DRAINAGE STRUCTURES AND DITCHES DURING ALL PHASES OF CONSTRUCTION SUCH THAT IMPACT TO CONSTRUCTION AND/OR SURROUNDING FACILITIES IS MINIMIZED. THE CONTRACTOR SHALL BE RESPONSIBLE FOR ANY EROSION, SEDIMENT TRANSPORT, DISTURBED FOUNDATIONS, IMPACT TO STRUCTURES AND ANY OTHER DAMAGE CAUSED DURING CONSTRUCTION.
- ANY SURVEY MARKER, INCLUDING BUT NOT LIMITED TO SECTION MARKERS, BENCH MARKS, LOT CORNERS, ETC. WHICH ARE DISTURBED DURING CONSTRUCTION SHALL BE REPLACED AT THE CONTRACTOR'S EXPENSE PRIOR TO FINAL PAYMENT. RESETTING OF MONUMENTS AND MARKERS SHALL BE PERFORMED BY A PROFESSIONAL LAND SURVEYOR LICENSED TO PRACTICE IN THE STATE OF FLORIDA.
- ALL DETAILS, SECTIONS AND NOTES SHOWN ON DRAWINGS ARE INTENDED TO BE TYPICAL AND SHALL APPLY TO SIMILAR SITUATIONS ELSEWHERE UNLESS NOTED OR SHOWN OTHERWISE.

EROSION CONTROL NOTES:

- ALL EROSION AND SEDIMENT CONTROL DEVICES NECESSARY FOR CONSTRUCTION SHALL CONFORM TO THE FLORIDA DEPARTMENT OF TRANSPORTATION (FDOT) STANDARD PLANS FOR ROADWAY AND BRIDGE CONSTRUCTION, ST. JOHNS RIVER WATER MANAGEMENT DISTRICT (SJRWMD) RULES, AND FLORIDA BEST MANAGEMENT PRACTICES.

SIGNING AND MARKING TABULATION OF QUANTITIES*

PAY ITEM NO.	DESCRIPTION	UNIT	SHEET NUMBERS				GRAND TOTAL	
			06		07		PLAN	FINAL
			PLAN	FINAL	PLAN	FINAL		
0700-1-11	SINGLE POST SIGN, F&I GROUND MOUNT, UP TO 12 SF	AS	2		2		4	
0700-3-101	SIGN PANEL, FURNISH & INSTALL GROUND MOUNT, UP TO 12 SF	EA	2		2		4	
0706-1-3	RAISED PAVEMENT MARKER, TYPE B	EA	216		144		360	
0710-90	PAINTED PAVEMENT MARKINGS, FINAL SURFACE	LS	-		-		1	
0711-11-123	THERMOPLASTIC, STANDARD, WHITE, SOLID, 12" FOR CROSSWALK AND ROUNDABOUT	LF	0		101		101	
0711-11-124	THERMOPLASTIC, STANDARD, WHITE, SOLID, 18" FOR DIAGONALS AND CHEVRONS	LF	851		593		1444	
0711-11-141	THERMOPLASTIC, STANDARD, WHITE, 2-4 DOTTED GUIDELINE, 6"	GM	0.115		0.152		0.267	
0711-11-170	THERMOPLASTIC, STANDARD, WHITE, ARROW	EA	1		1		2	
0711-14-160	THERMOPLASTIC, PREFORMED, WHITE, MESSAGE	EA	8		6		14	
0711-16-101	THERMOPLASTIC, STANDARD-OTHER SURFACES, WHITE, SOLID, 6"	GM	0.230		0.167		0.397	
0711-16-102	THERMOPLASTIC, STANDARD-OTHER SURFACES, WHITE, SOLID, 8"	GM	0.388		0.269		0.657	
0711-16-171	THERMOPLASTIC, STANDARD OTHER SURFACES, WHITE, 6", 6-10 DOTTED MANAGED LANE MARKING	GM	0.049		0.075		0.123	

*FOR INFORMATION ONLY

PAY ITEM NOTES

0711 SERIES SHALL INCLUDE THE REMOVAL OF CONFLICTING PAVEMENT MARKINGS WITH PAYMENT.

SIGNING AND PAVEMENT MARKING NOTES

- ALL ALL EXISTING SIGNS ARE TO REMAIN UNLESS NOTED OTHERWISE ON THE PLANS.
- ALL SPECIAL CROSSWALKS SHALL BE 10 WIDE UNLESS OTHERWISE SHOWN ON THE PLANS.
- THE PAVEMENT MARKINGS AT ALL EXISTING/PROPOSED INTERFACE LOCATIONS ARE TO MATCH IN TERMS OF AUGMENT.
- RAISED PAVEMENT MARKERS ARE TO BE PLACED IN ACCORDANCE WITH THESE PLANS AND FDOT STANDARD PLANS INDEX 706-001.
- FIFTEEN MINUTES PRIOR TO INITIATING MAINTENANCE OF TRAFFIC FOR A LANE CLOSURE, THE CONTRACTOR SHALL CONTACT THE DISTRICT TWO RTMC AT (904) 903-2000 TO PROVIDE INFORMATION ON THE ROADWAY, DIRECTION OF TRAVEL, AND WHICH LANE(S) WILL BE CLOSED. ONCE THE WORK IS COMPLETE AND LANES ARE REOPENED, CONTACT THE DISTRICT TWO RTMC WITHIN THIRTY MINUTES TO NOTIFY THEM THAT THE CLOSURES HAVE BEEN REMOVED.
- ALL SIGNING AND PAVEMENT MARKINGS OUTSIDE OF FDOT RIGHT-OF-WAY SHALL MEET CITY OF GAINESVILLE STANDARDS.

FDOT GENERAL NOTES

- ALL WORK PERFORMED WITHIN THE FLORIDA DEPARTMENT OF TRANSPORTATION RIGHT-OF-WAY SHALL CONFORM TO THE FOLLOWING:
 - STANDARD SPECIFICATIONS FOR ROAD AND BRIDGE CONSTRUCTION (JULY 2022)
 - FDOT STANDARD PLANS (FY 2022-2023)
 - FDOT DESIGN MANUAL (2022)
 - FDOT FLEXIBLE PAVEMENT DESIGN MANUAL (JANUARY 2020)

SHOULD A CONFLICT ARISE BETWEEN THE DETAILS, SHOWN ON THESE PLANS AND THE DEPARTMENT OF TRANSPORTATION STANDARDS, THE ENGINEER/PERMITEE SHALL IMMEDIATELY CONFER WITH THE DISCREPANCY. IN NO CASE WILL ANYTHING LESS THAN THE DEPARTMENT'S MINIMUM STANDARD BE ALLOWED.
- ALL CURB AND GUTTER AND SIDEWALK WILL BE REMOVED AND REPLACED JOINT TO JOINT.
- ALL DISTURBED AREA WITHIN THE DEPARTMENT OF TRANSPORTATION RIGHT-OF-WAY WILL BE RESOTRED TO EQUAL OR BETTER CONDITION BY GRADING AND SODDING THE AREA DISTURBED (COMMON BERMUDA SOD IN UTILITY STRIPS).

CITY OF GAINESVILLE GENERAL NOTES

- ALL WORK PERFORMED WITHIN THE CITY OF GAINESVILLE RIGHT-OF-WAY SHALL CONFORM TO THE CITY OF GAINESVILLE ENGINEERING DESIGN AND CONSTRUCTION MANUAL (CURRENT EDITION).
- AS-BUILT INFORMATION (DWG AND PDF) TO BE PROVIDED TO THE CITY OF GAINESVILLE.

TEMPORARY TRAFFIC CONTROL NOTES

- TRAFFIC CONTROL FOR THIS PROJECT SHALL BE IN ACCORDANCE WITH THE CURRENT EDITION OF THE MANUAL ON UNIFORM TRAFFIC CONTROL DEVICES (MUTCD) AND THE FLORIDA DEPARTMENT OF TRANSPORTATION (FDOT) STANDARD PLANS.
- VEHICULAR, BICYCLE, PEDESTRIAN AND TRANSIT ROUTES SHALL BE PROVIDED AT ALL TIMES.
- CONTRACTOR SHALL ACCOUNT FOR OTHER AREAS OF CONSTRUCTION THAT MAY BE NEARBY. CONTRACTOR TO COORDINATE ALL ROADWAY CONSTRUCTION ZONE SIGNAGE FOR CONSISTENCY.
- ALL TEMPORARY PEDESTRIAN PATHS TO MEET ADA REQUIREMENTS.

UTILITY NOTES:

- THE CONTRACTOR SHALL NOTIFY UTILITY OWNERS THROUGH SUNSHINE STATE ONE CALL OF FLORIDA (1-800-432-4770) AND UTILITY OWNERS LISTED ON THE COVER SHEET IN TWO BUSINESS DAYS (OR 10 DAYS IF DIGGING UNDER WATER) IN ADVANCE OF BEGINNING CONSTRUCTION ON THE JOB SITE.

UTILITY AGENCY CONTACTS

AT&T	DINO FARRUGGIO	(561) 683-2729
CITY OF GAINESVILLE TRAFFIC MANAGEMENT	CHRIS DOLAN	(352) 393-8180
COX CABLE	RANDY EHLERS	(352) 337-2009
GAINESVILLE REGIONAL UTILITIES	MICHAEL CHAPPELL	(352) 393-6923
GAINESVILLE REGIONAL UTILITIES	PHILLIP LANCASTER	(352) 334-6078
GAINESVILLE REGIONAL UTILITIES	ANDREW ROBERTS	(352) 393-1639
GAINESVILLE REGIONAL UTILITIES	RENEE ZAMOT-AYALA	(352) 393-6039
MCI	INVESTIGATIONS TEAM	(800) 624-9675 EXT 2
UNITI FIBER	BOB MENSCHING	(904) 718-8152

THE CONTRACTOR SHALL BE RESPONSIBLE FOR DAMAGE TO UTILITIES, STRUCTURES, AND PROPERTY ON AND ADJACENT TO THE SITE CAUSED BY CONSTRUCTION ACTIVITIES.

REVISIONS		DATE	 © 2023 KIMLEY-HORN AND ASSOCIATES, INC. 800 SW 2ND AVENUE, SUITE 100, GAINESVILLE, FL 32601 PHONE: 352-374-3274 WWW.KIMLEY-HORN.COM REGISTRY 35106	LICENSED PROFESSIONAL	CITY OF GAINESVILLE			GENERAL NOTES AND TABULATION OF QUANTITIES	SHEET NO.
DATE	DESCRIPTION	MARCH 2023		ALI H. BRIGHTON P.E.	ROAD NO.	COUNTY	PROJECT NO.		03
-	NOT FOR CONSTRUCTION			77731	NW 8TH AVE	ALACHUA	142107008		

This document, together with the concepts and designs presented herein, is intended only for the specific purpose and client for which it was prepared. Review of and proper reliance on this document without written authorization and adaptation by Kimley-Horn and Associates, Inc. shall be without liability to Kimley-Horn and Associates, Inc.

This document, together with the concepts and designs presented herein, is intended only for the specific purpose and client for which it was prepared. Review of and improper reliance on this document without written authorization and adaptation by Kimley-Horn and Associates, Inc. will be without liability to Kimley-Horn and Associates, Inc.

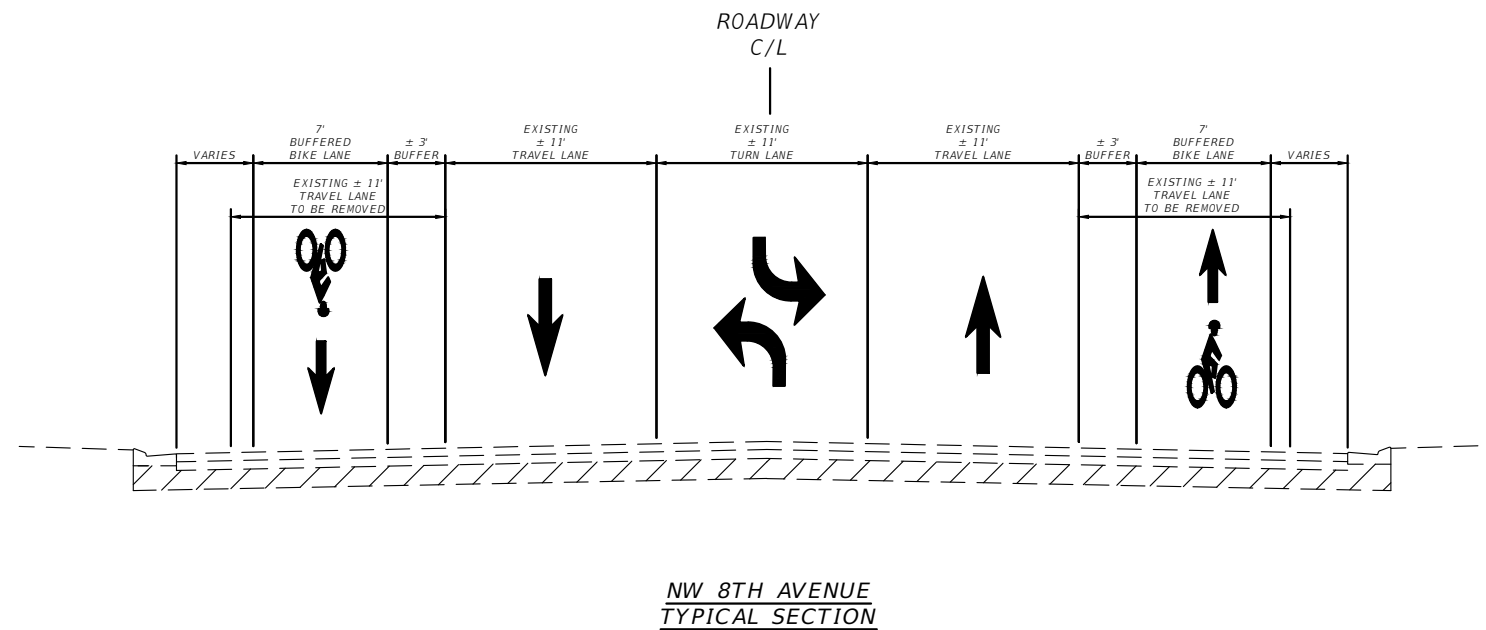

REVISIONS		DATE	 <small>© 2023 KIMLEY-HORN AND ASSOCIATES, INC. 800 SW 2ND AVENUE, SUITE 100, GAINESVILLE, FL 32601 PHONE: 352-374-3274 WWW.KIMLEY-HORN.COM REGISTRY 35106</small>	LICENSED PROFESSIONAL	CITY OF GAINESVILLE NW 8TH AVE MODIFICATIONS			TYPICAL SECTIONS	SHEET NO.
DATE	DESCRIPTION	MARCH 2023		ALI H. BRIGHTON P.E.	ROAD NO.	COUNTY	PROJECT NO.		04
- -	NOT FOR CONSTRUCTION			77731	NW 8TH AVE	ALACHUA	142107008		
				DATE:					

This document, together with the concepts and designs presented herein, is intended only for the specific purpose and client for which it was prepared. Review of this document without written authorization and adaptation by Kimley-Horn and Associates, Inc. shall be without liability to Kimley-Horn and Associates, Inc.

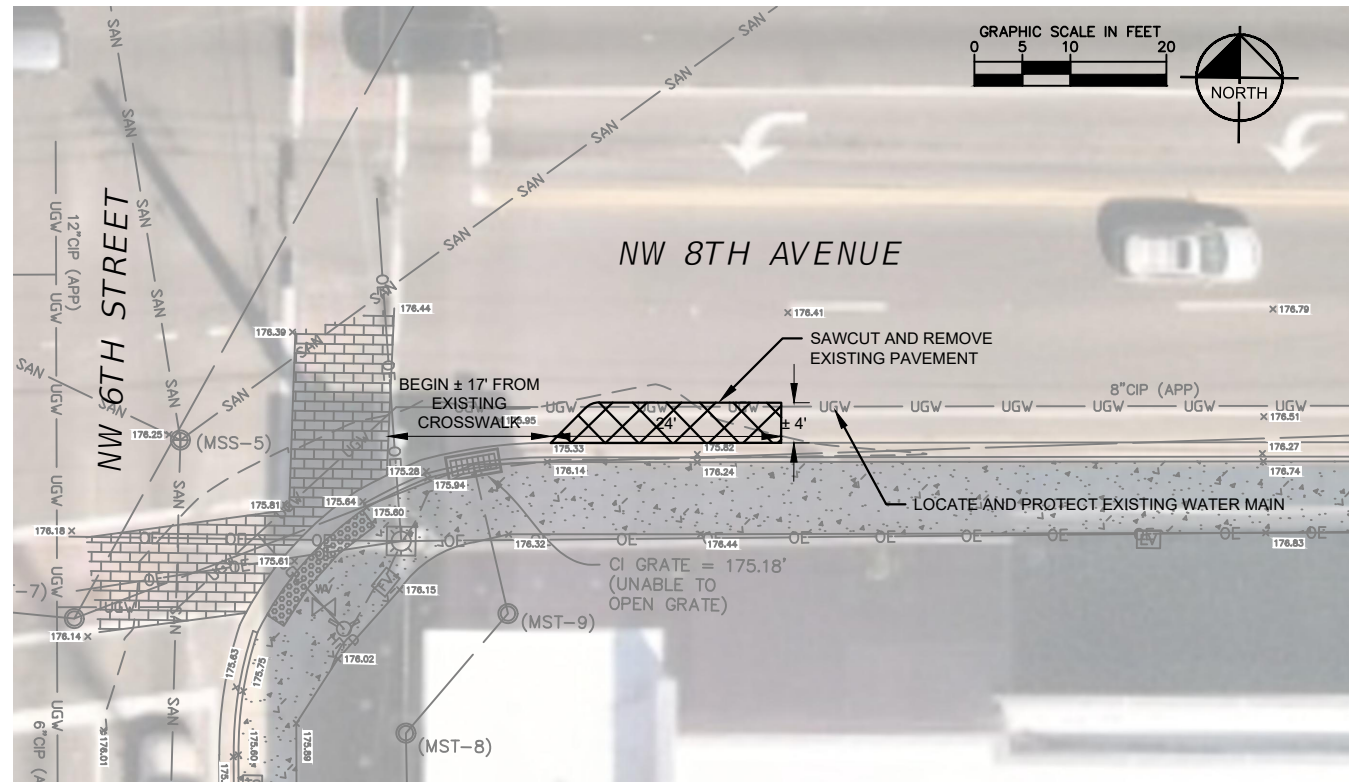

DEMOLITION - NW 8TH AVENUE AT NW 6TH STREET

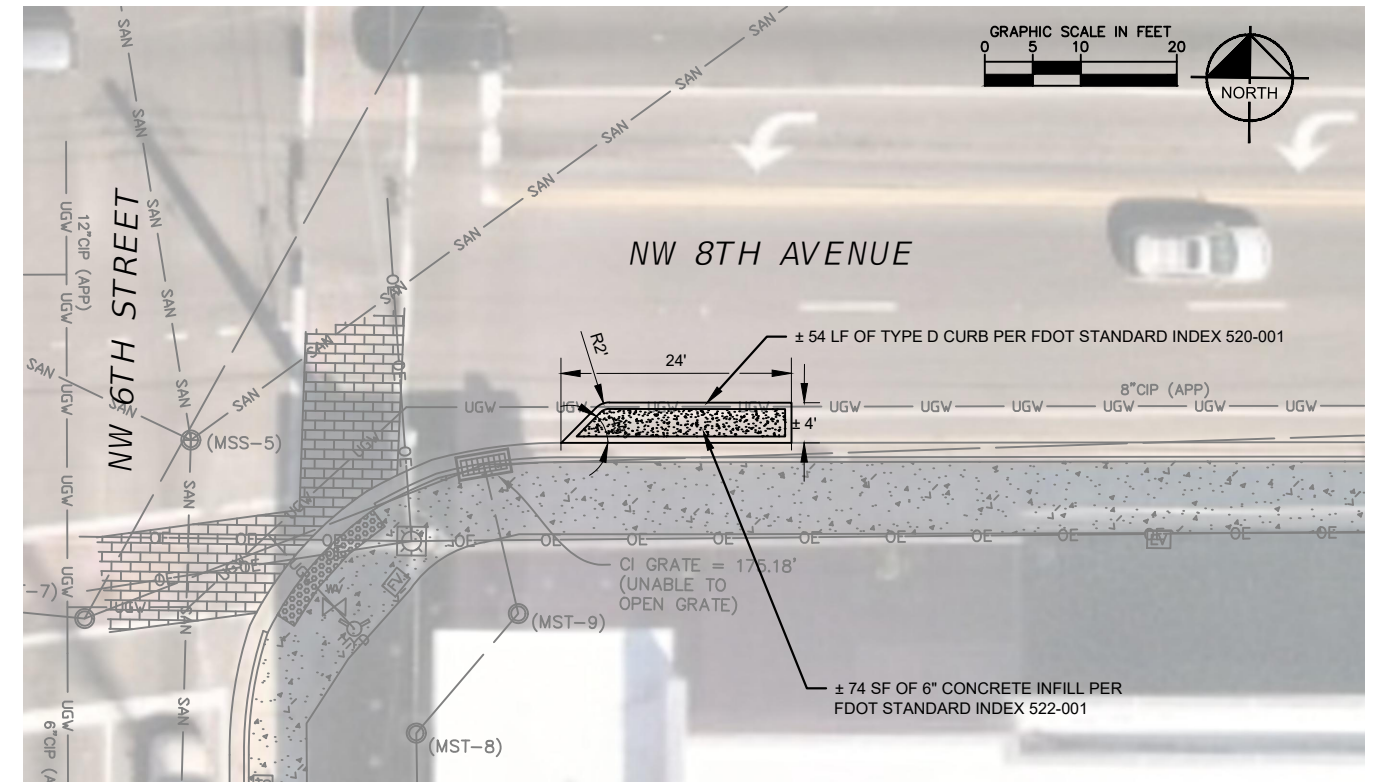

CURB MODIFICATIONS - NW 8TH AVENUE AT NW 6TH STREET

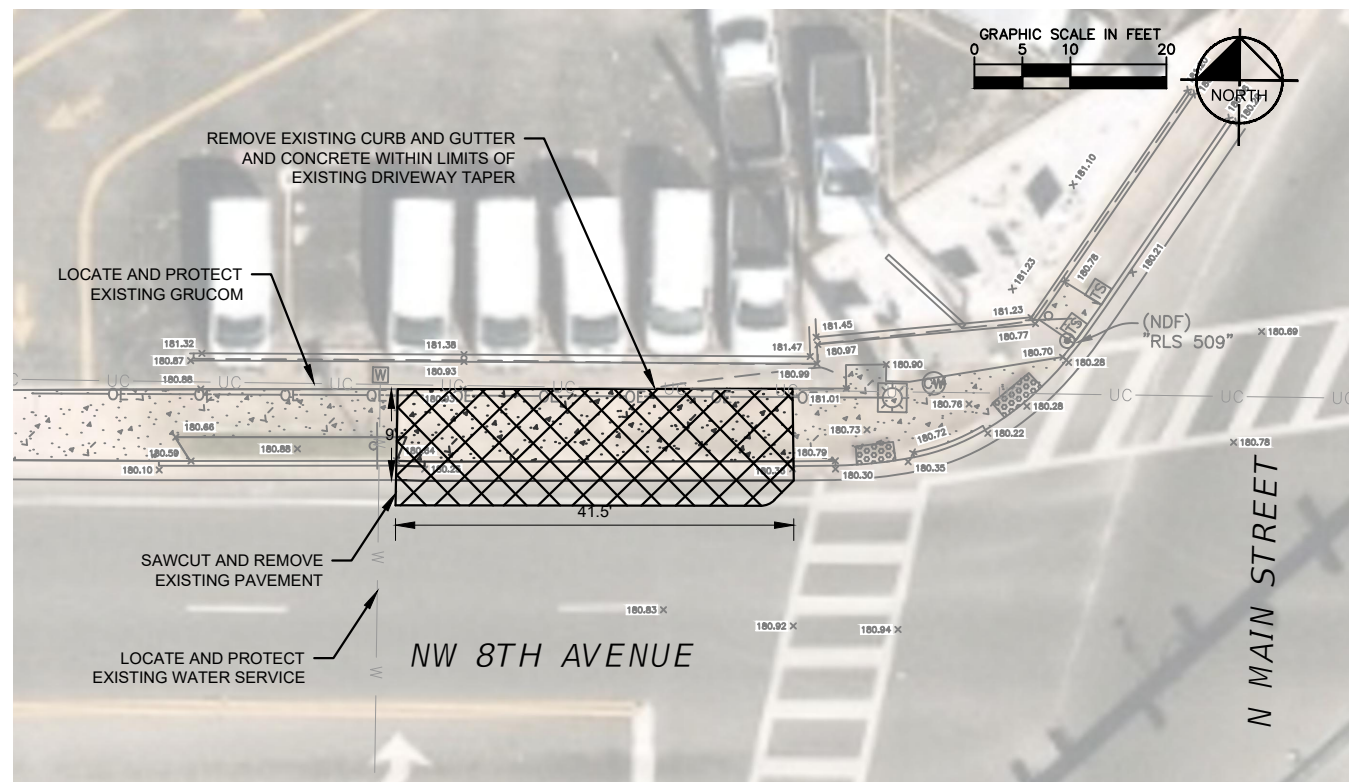

DEMOLITION - NW 8TH AVENUE AT N MAIN STREET

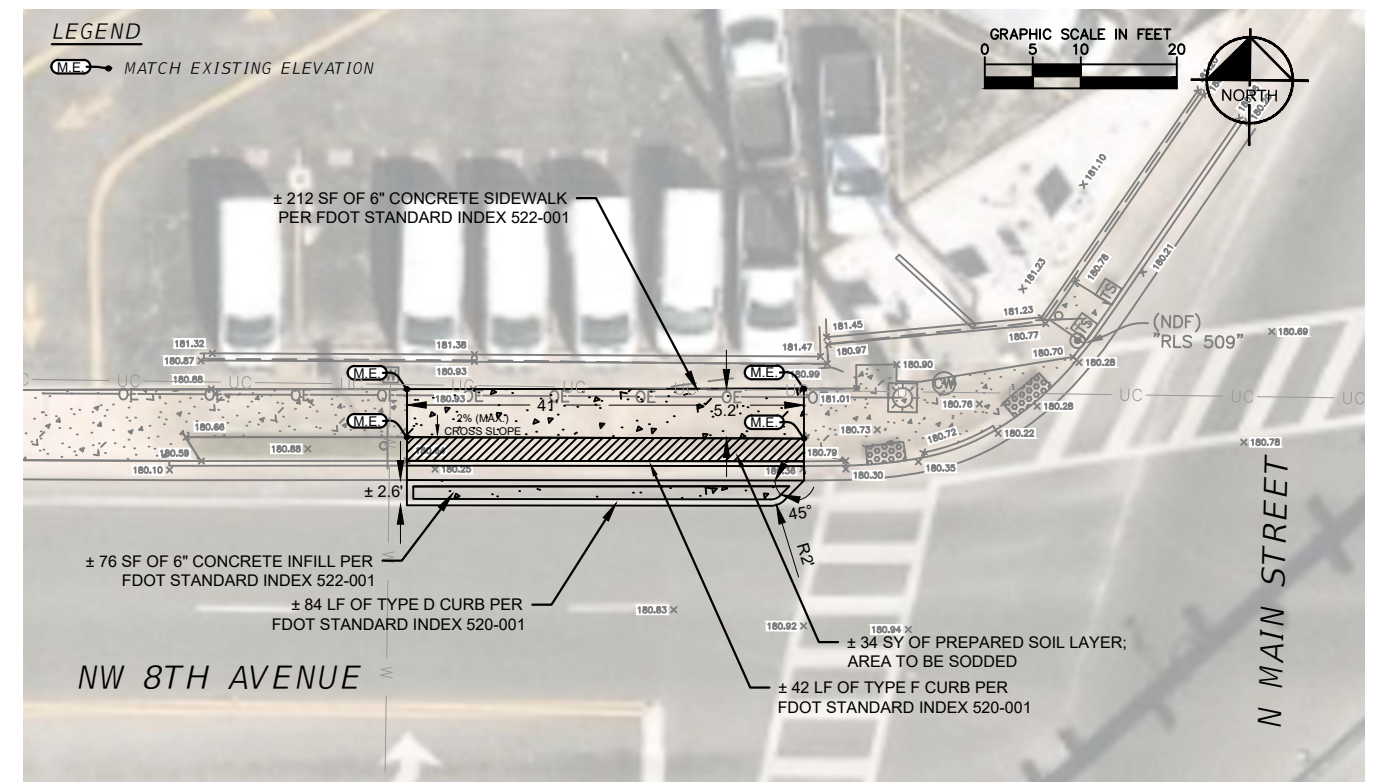

CURB MODIFICATIONS - NW 8TH AVENUE AT N MAIN STREET

REVISIONS		DATE		LICENSED PROFESSIONAL CHRISTOPHER D. TOWNE, P.E. 66928 DATE:	CITY OF GAINESVILLE NW 8TH AVE MODIFICATIONS			DEMOLITION AND CURB MODIFICATION DETAILS	SHEET NO. 05
DATE	DESCRIPTION	MARCH 2023			ROAD NO.	COUNTY	PROJECT NO.		
- -	NOT FOR CONSTRUCTION		© 2023 KIMLEY-HORN AND ASSOCIATES, INC. 800 SW 2ND AVENUE, SUITE 100, GAINESVILLE, FL 32601 PHONE: 352-374-3274 WWW.KIMLEY-HORN.COM REGISTRY 35106		NW 8TH AVE	ALACHUA	142107008		

This document, together with the concepts and designs presented herein, is intended only for the specific purpose and client for which it was prepared. Review and proper reliance on this document without written authorization and adaptation by Kimley-Horn and Associates, Inc. will be without liability to Kimley-Horn and Associates, Inc.

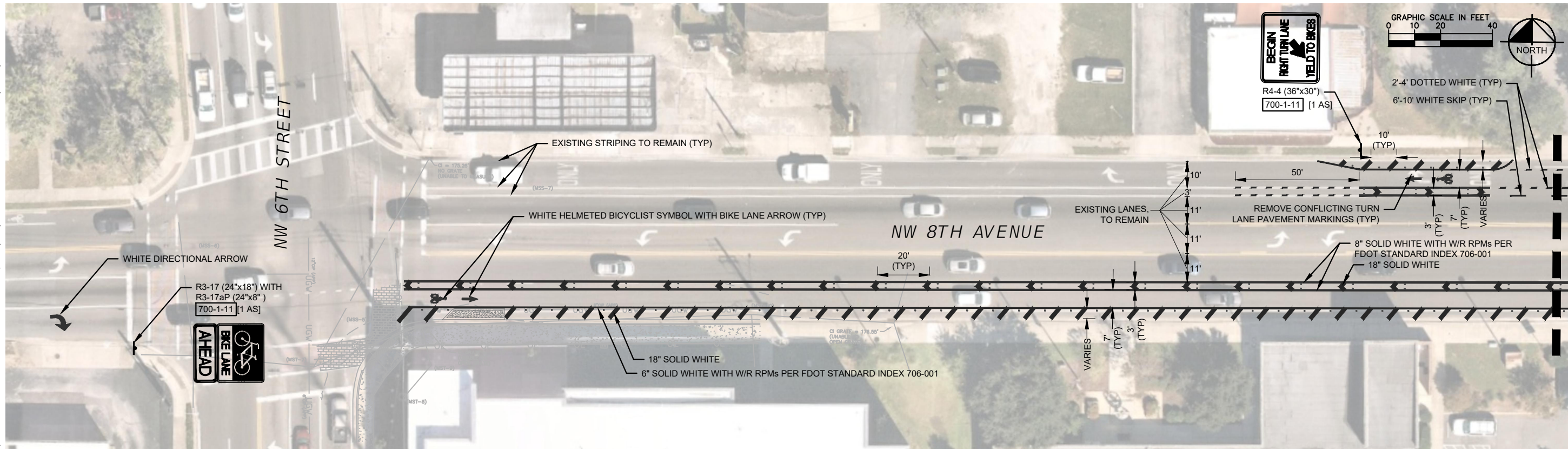

MATCHLINE - SEE BELOW

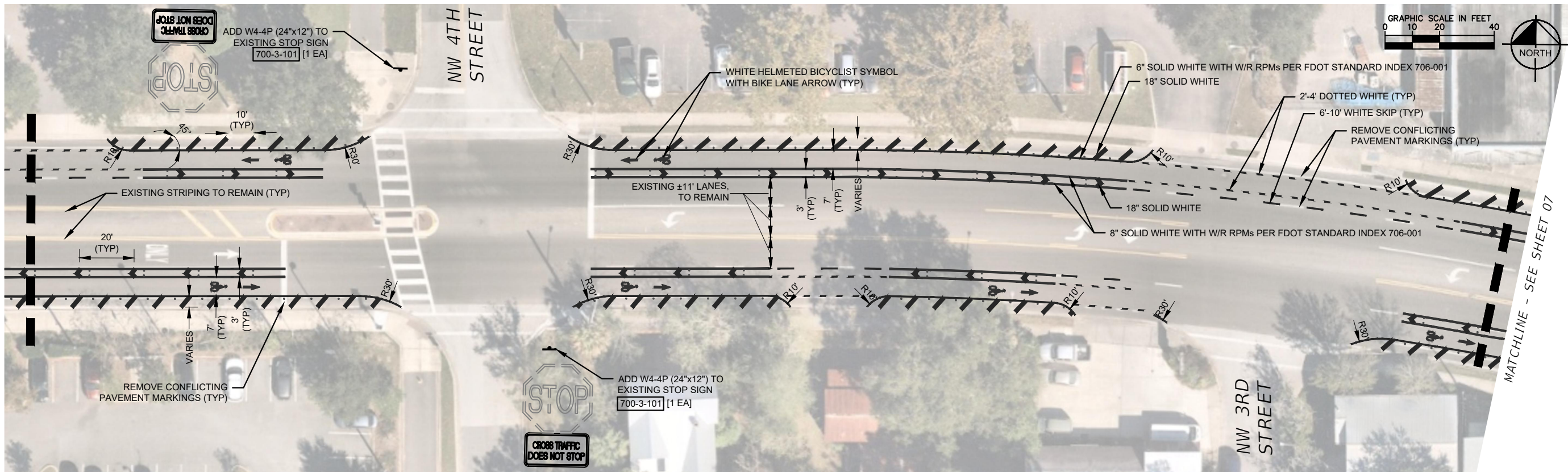

MATCHLINE - SEE ABOVE

MATCHLINE - SEE SHEET 07

REVISIONS	
DATE	DESCRIPTION
- -	NOT FOR CONSTRUCTION

DATE	MARCH 2023
DESIGNED BY	KHA
DRAWN BY	BAD
CHECKED BY	AHB

Kimley»Horn

© 2023 KIMLEY-HORN AND ASSOCIATES, INC.
 800 SW 2ND AVENUE, SUITE 100, GAINESVILLE, FL 32601
 PHONE: 352-374-3274
 WWW.KIMLEY-HORN.COM REGISTRY 35106

LICENSED PROFESSIONAL	ALI H. BRIGHTON P.E.
	77731
DATE:	

CITY OF GAINESVILLE NW 8TH AVE MODIFICATIONS		
ROAD NO.	COUNTY	PROJECT NO.
NW 8TH AVE	ALACHUA	142107008

SIGNING AND MARKING PLAN

SHEET NO.	06
-----------	----

This document, together with the concepts and designs presented herein, is intended only for the specific purpose and client for which it was prepared. Review and improve reliance on this document without written authorization and adaptation by Kimley-Horn and Associates, Inc. will be without liability to Kimley-Horn and Associates, Inc.

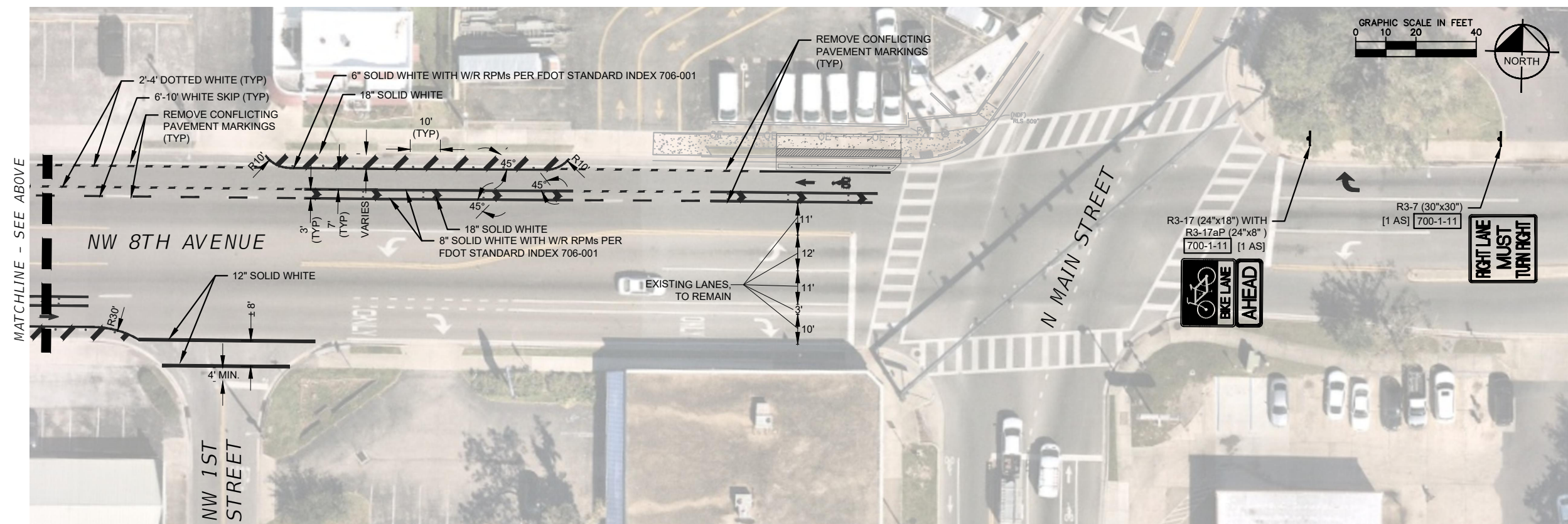
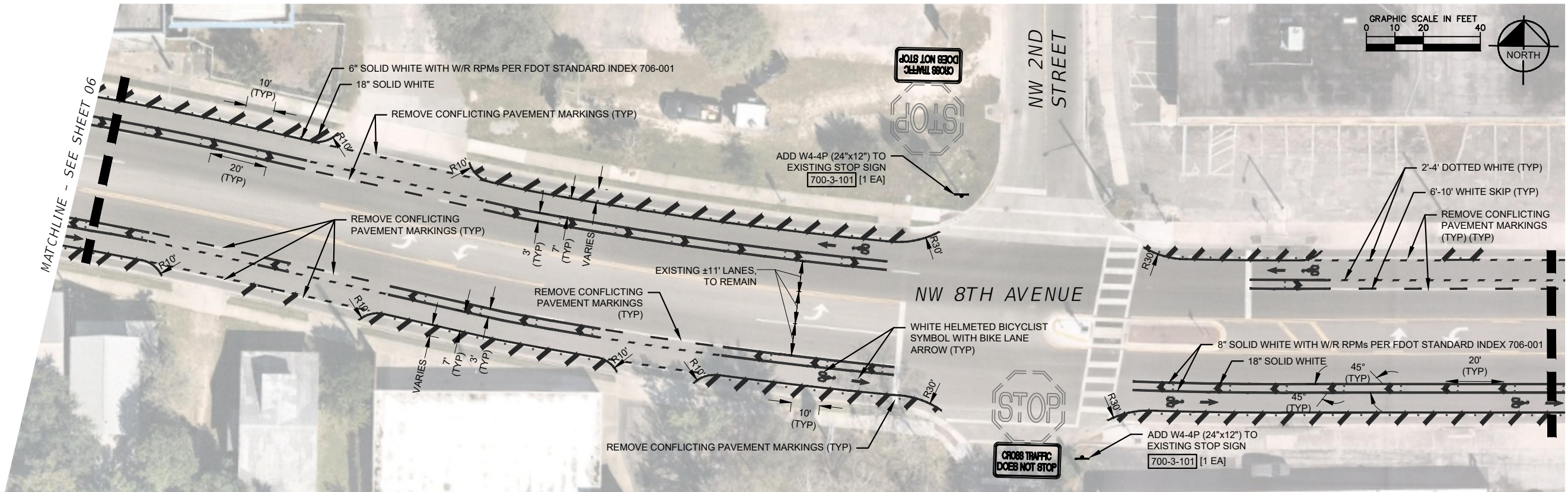

REVISIONS	
DATE	DESCRIPTION

DATE	MARCH 2023
DESIGNED BY	KHA
DRAWN BY	BAD
CHECKED BY	AHB

Kimley-Horn

© 2023 KIMLEY-HORN AND ASSOCIATES, INC.
 800 SW 2ND AVENUE, SUITE 100, GAINESVILLE, FL 32601
 PHONE: 352-374-3274
 WWW.KIMLEY-HORN.COM REGISTRY 35106

LICENSED PROFESSIONAL
 ALI H. BRIGHTON P.E.
 77731
 DATE: 3/22/2023 4:34:25 PM

CITY OF GAINESVILLE NW 8TH AVE MODIFICATIONS		
ROAD NO.	COUNTY	PROJECT NO.
NW 8TH AVE	ALACHUA	142107008

SIGNING AND MARKING PLAN

SHEET NO.
07